

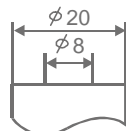

Dimensions

mm(inch)



(M8 Bolt)

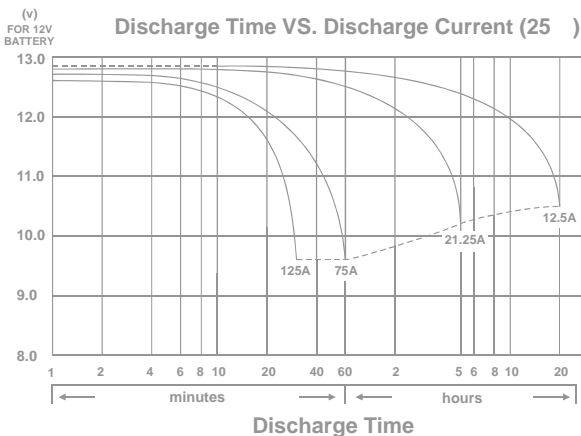
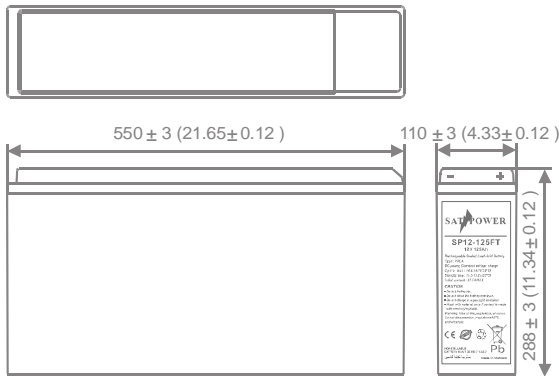

SP12-125FT

Specifications

Nominal Voltage(V) 12V

Nominal Capacity

10 hour rate	(12.5A to 10.80V)	125Ah
5 hour rate	(21.25A to 10.20V)	106.3Ah
1 hour rate	(75A to 9.60V)	75Ah
1 C	(125A to 9.60V)	62.5Ah

Weight Approx. 39kg(85.8Lbs.)

Internal Resistance (at 1KHz) Approx. 7 mΩ

Maximum Discharge Current for

5 seconds: 1250A

Charging Methods at 25 °C (77 °F)

Cycle use:

Charging Voltage 14.4 to 14.7V

Coefficient -5.0mV/°C /cell

Maximum Charging Current : 37.5A

Standby use:

Float Charging Voltage 13.5 to 13.8V

Coefficient -3.0mV/°C /cell

Operating Temperature Range

Charge -15 (5 °F) to 40 (104 °F)

Discharge -15 (5 °F) to 50 (122 °F)

Storage -15 (5 °F) to 40 (104 °F)

Charge Retention (shelf life) at 20 °C (68 °F)

1 month 98%

3 month 94%

6 month 85%

Case Material

ABS

(UL94-V0)

Terminal

F18

Description of torque value of hard ware for the terminals:

Recommended torque value M8: 7.35 N-m (75kg-cm)

Maximum allowable torque value M8: 9.8 N-m (100kg-cm)

Applications

- UPS System
- Alarm Systems & Security equipment
- Telephone & telecom equipment
- Emergency lighting
- Fire & gas detection devices
- Portable measuring instruments
- Medical equipment
- Portable video cameras & television
- Solar systems
- Power tools

- PERFORMANCE DATA

Discharge Rates in Amperes to Various End Voltages at 25 (77)

Time	End Voltage	1.85V	1.8V	1.75V	1.70V	1.67V	1.65V	1.60V
15	min	153	188	213	226	230	235	241
30	min	89.2	108	121	129	131	134	137
60	min	70.4	75.9	77.8	79.5	80.1	80.8	81.6
120	min	38.2	42.3	44.0	45.3	45.7	45.2	45.8
180	min	27.7	30.8	31.9	32.8	33.1	33.5	34.0
240	min	22.6	24.8	25.7	26.4	26.6	26.9	27.2
300	min	19.9	21.3	22.1	22.6	22.7	22.9	23.1
480	min	14.3	15.2	15.6	15.8	15.9	16.0	16.1
600	min	11.8	12.6	13.0	13.3	13.4	13.5	13.6
1200	min	6.42	6.63	6.72	6.79	6.82	6.85	6.89

Discharge Rates in Watts to Various End Voltages at 25 (77)

Time	End Voltage	1.85V	1.8V	1.75V	1.70V	1.67V	1.65V	1.60V
15	min	1606	1970	2219	2379	2425	2477	2530
30	min	956	1173	1321	1417	1442	1475	1507
60	min	818	874	909	930	936	944	951
120	min	463	497	511	523	527	531	535
180	min	356	381	392	400	403	406	409
240	min	291	306	315	322	324	327	330
300	min	245	258	267	274	276	279	281
480	min	170	179	186	191	192	194	196
600	min	147	153	158	162	163	164	165
1200	min	75.8	79.0	80.9	82.5	83.1	83.8	84.5

All data on the spec. sheet is an average value:

The tolerance range : X<6min(+15%~-15%), 6min X<10min(+12%~-12%),10min X < 60min(+8%~-8%), X 60min(+5%~-5%)

Effect of Temperature on Capacity 25 (77)

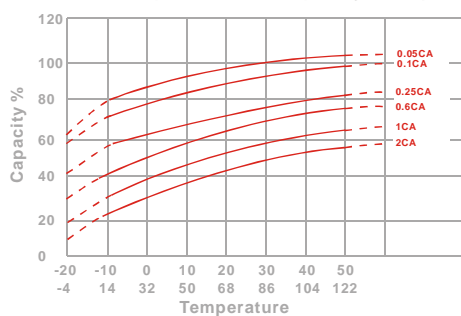

Capacity Retention Characteristic

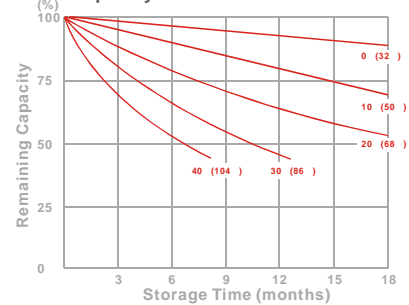

Trickle (or float) Service Life

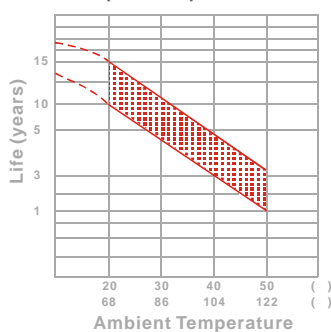

Cycle Service Life

