

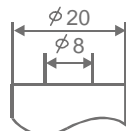

Dimensions

mm(inch)



(M8 Bolt)

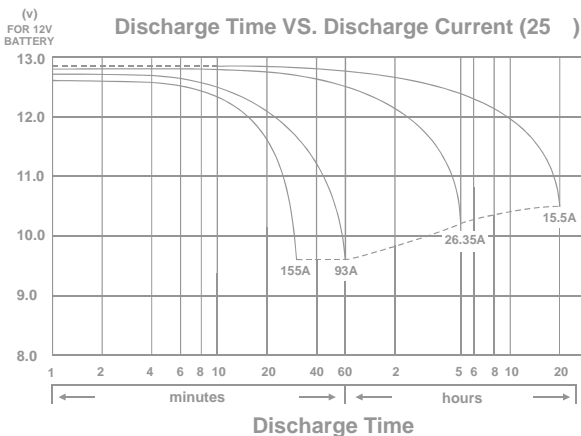
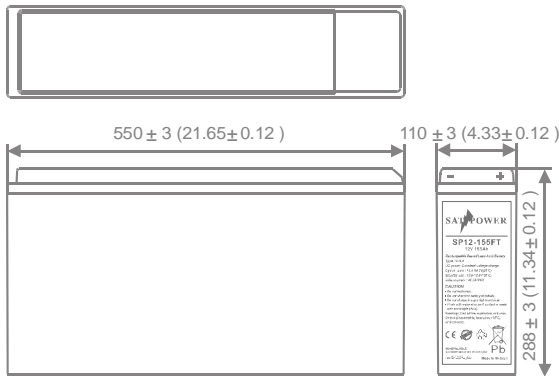

SP12-155FT

Specifications

Nominal Voltage(V) 12V

Nominal Capacity

10 hour rate	(15.5A	to	10.80V)	155Ah
5 hour rate	(26.35A	to	10.20V)	131.8Ah
1 hour rate	(93A	to	9.60V)	93Ah
1 C	(155A	to	9.60V)	77.5Ah

Weight Approx. 49kg(108Lbs.)

Internal Resistance (at 1KHz) Approx. 4.5 mΩ

Maximum Discharge Current for

5 seconds: 1550A

Charging Methods at 25 °C (77 °F)

Cycle use:

Charging Voltage 14.4 to 14.7V

Coefficient -5.0mV/°C /cell

Maximum Charging Current : 46.5A

Standby use:

Float Charging Voltage 13.5 to 13.8V

Coefficient -3.0mV/°C /cell

Operating Temperature Range

Charge -15 (5 °C) to 40 (104 °F)

Discharge -15 (5 °C) to 50 (122 °F)

Storage -15 (5 °C) to 40 (104 °F)

Charge Retention (shelf life) at 20 °C (68 °F)

1 month 98%

3 month 94%

6 month 85%

Case Material

ABS

(UL94-V0)

Terminal

F18

Description of torque value of hard ware for the terminals:

Recommended torque value M8: 7.35 N-m (75kg-cm)

Maximum allowable torque value M8: 9.8 N-m (100kg-cm)

Applications

- UPS System
- Alarm Systems & Security equipment
- Telephone & telecom equipment
- Emergency lighting
- Fire & gas detection devices
- Portable measuring instruments
- Medical equipment
- Portable video cameras & television
- Solar systems
- Power tools

- PERFORMANCE DATA

Discharge Rates in Amperes to Various End Voltages at 25 (77)

Time	End Voltage	1.85V	1.8V	1.75V	1.70V	1.67V	1.65V	1.60V
15	min	208	252	275	291	297	304	312
30	min	113	138	156	165	168	172	177
60	min	83.2	94.4	97.9	100	101	102	103
120	min	46.1	54.5	56.7	58.6	59.3	60.1	61.2
180	min	33.9	39.1	40.8	42.1	42.6	43.2	43.9
240	min	28.4	30.9	32.1	33.0	33.3	33.7	34.1
300	min	24.6	26.5	27.3	27.9	28.1	28.4	28.7
480	min	17.1	17.9	18.5	18.9	19	19.2	19.3
600	min	15.0	15.7	16.1	16.3	16.4	16.5	16.6
1200	min	7.82	8.14	8.38	8.47	8.52	8.57	8.62

Discharge Rates in Watts to Various End Voltages at 25 (77)

Time	End Voltage	1.85V	1.8V	1.75V	1.70V	1.67V	1.65V	1.60V
15	min	2080	2551	2874	3081	3142	3208	3278
30	min	1239	1520	1712	1835	1876	1923	1952
60	min	1026	1085	1107	1124	1131	1139	1147
120	min	587	618	639	675	681	688	705
180	min	454	483	498	511	516	522	528
240	min	352	376	389	400	404	409	414
300	min	299	317	329	338	341	345	349
480	min	227	238	246	243	245	248	251
600	min	182	189	194	198	199	201	203
1200	min	92.6	96.8	100	102	103	104	105

All data on the spec. sheet is an average value:

The tolerance range : X<6min(+15%~-15%), 6min X<10min(+12%~-12%),10min X < 60min(+8%~-8%), X 60min(+5%~-5%)

Effect of Temperature on Capacity 25 (77)

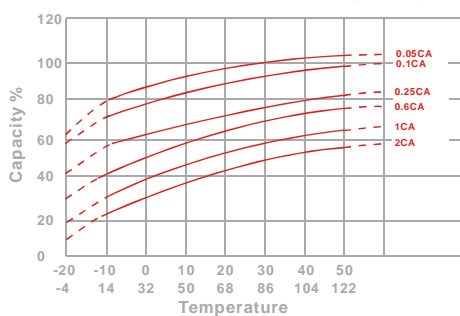

Capacity Retention Characteristic

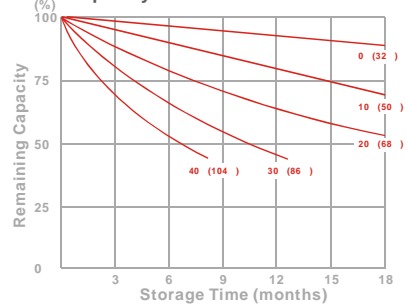

Trickle (or float) Service Life

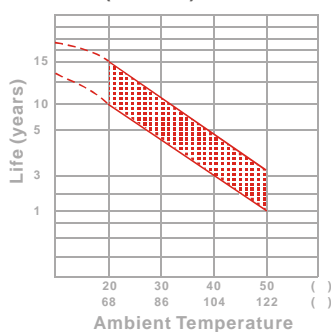

Cycle Service Life

